



Meetings & Events
Celebrate them in the Camp Nou



FCBARCELONA
més que un club

The Camp Nou Terrace

A large open-air terrace

Next to the pitch



Location map and facility description

Camp Nou Terrace

Spectacular 400 m2 terrace sited on the 1st rows seats in the grandstand next to the pitch

In the open air but protected from the sun and the rain by the grandstand's cantilever roof

Can host cocktail receptions, gala dinners, large presentations and shows

Unique assembly. Only available in the summer due to sports schedules

Option of adding to the outdoor facility with adjoining VIP rooms

Entrance from the Grandstand's main façade

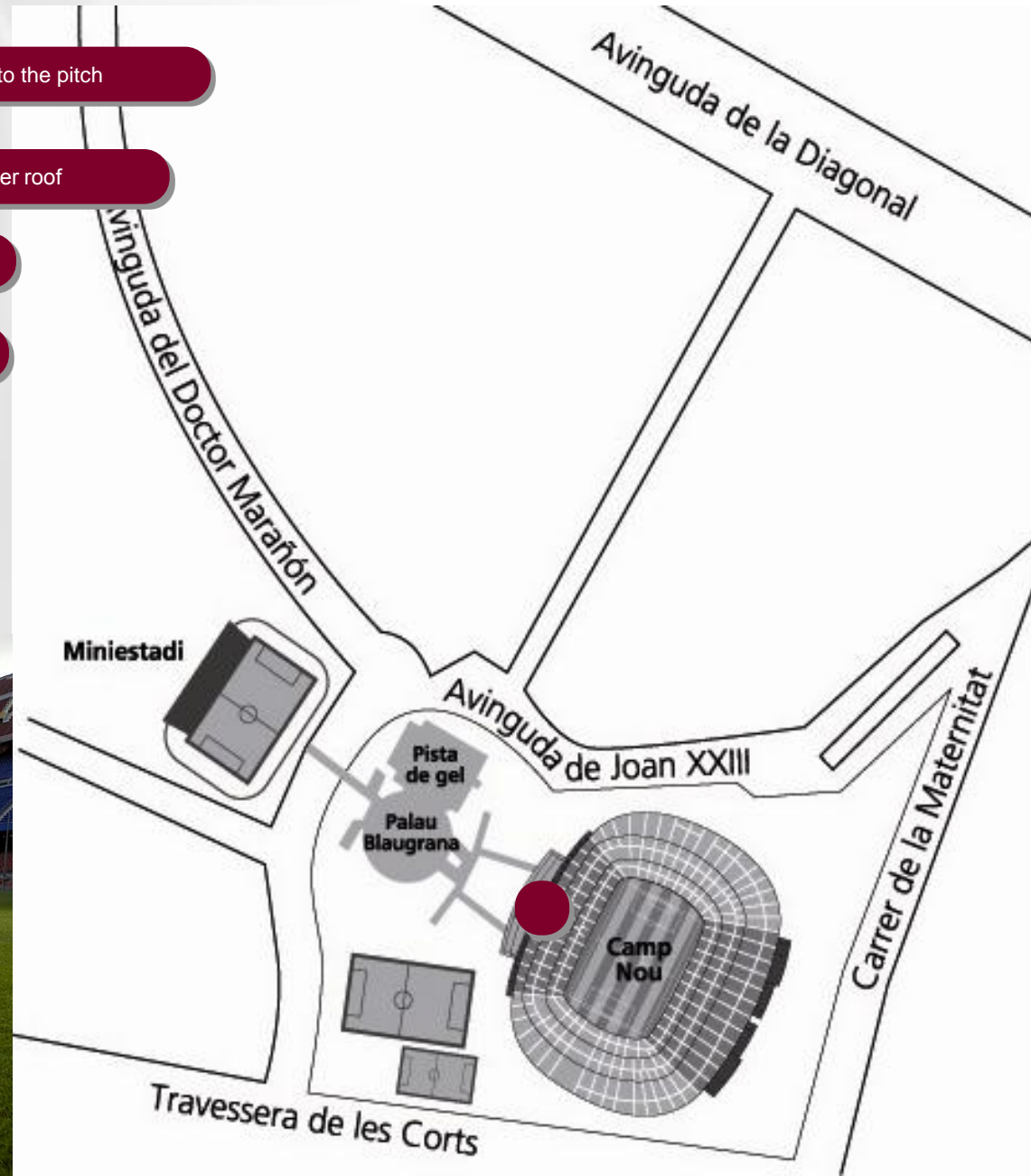



Facility plan (inside area)

Camp Nou Terrace

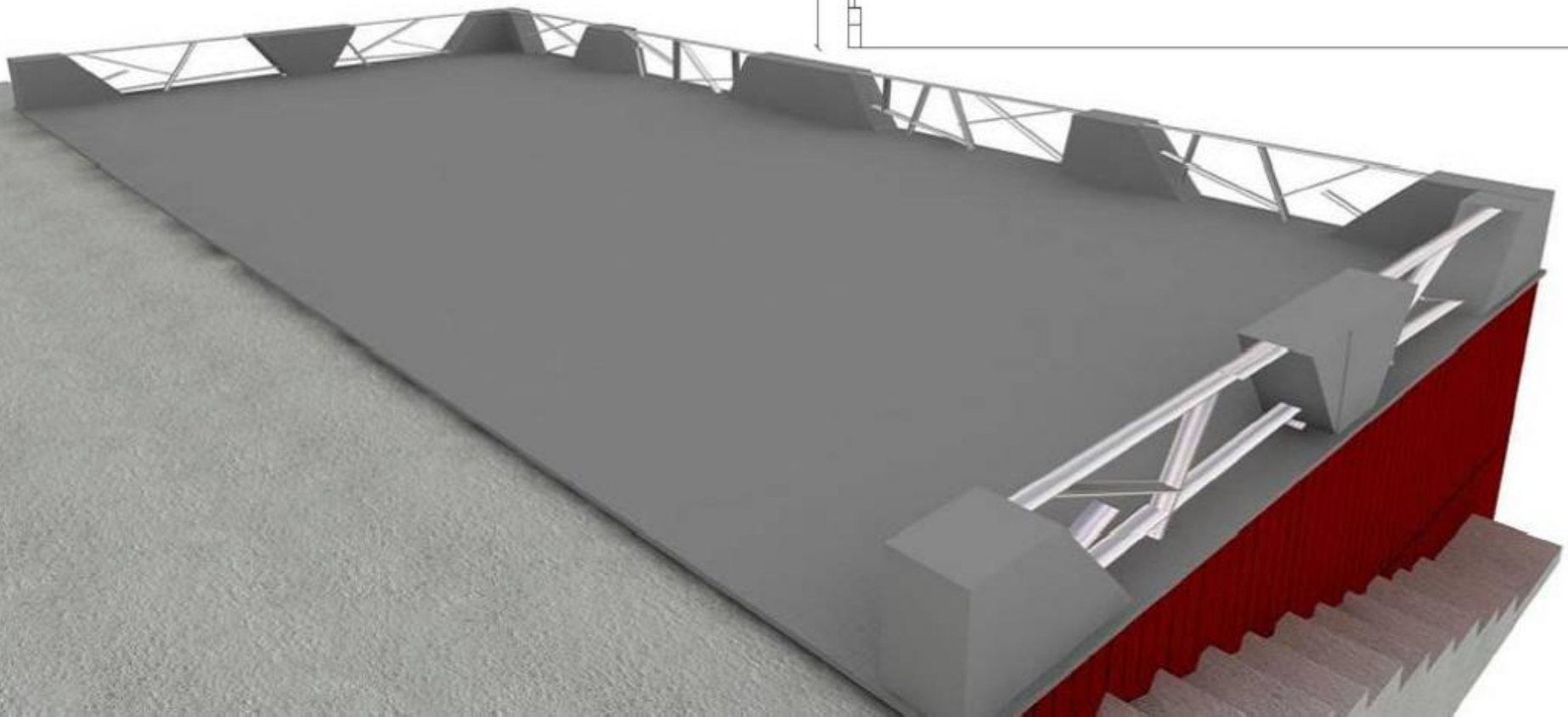
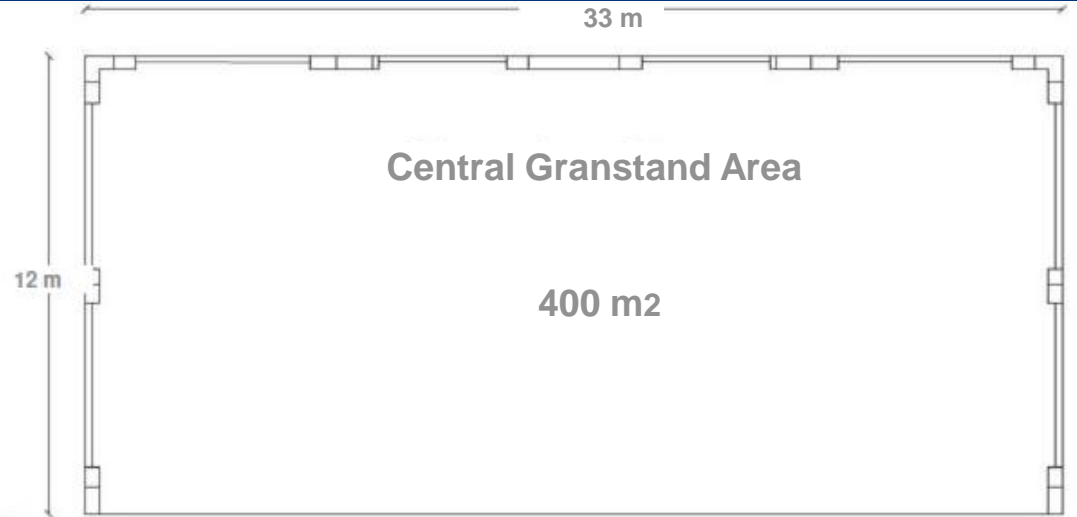



Facility features: outdoor access

Camp Nou Terrace

Glass wall with large illuminated statues

Customisation with back-lit items and giant logo projection

Access for guests up main staircase with option of red carpet at entrance

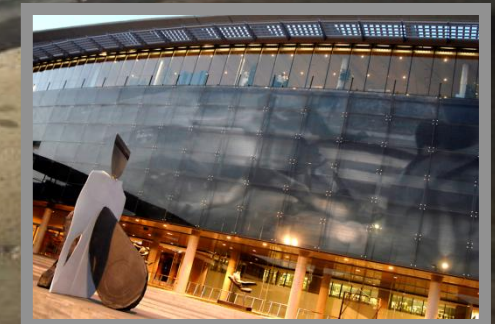
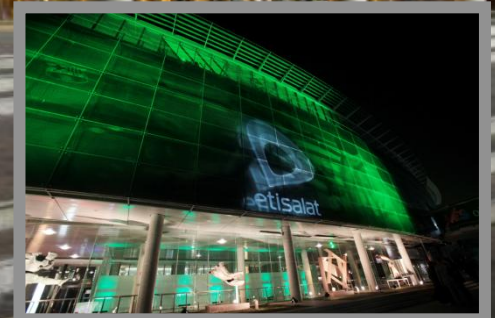
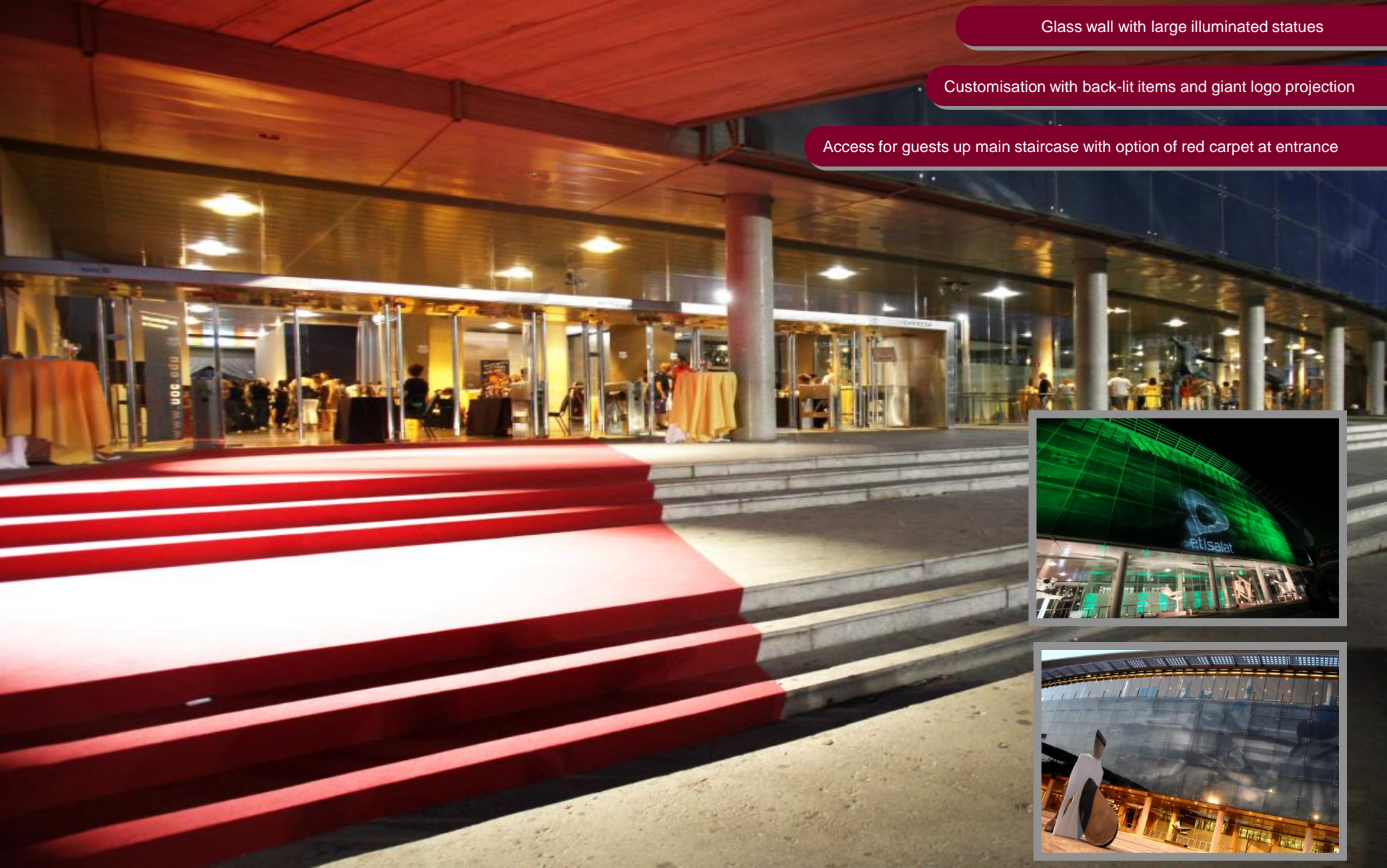



Facility features: Cocktail style

Camp Nou Terrace

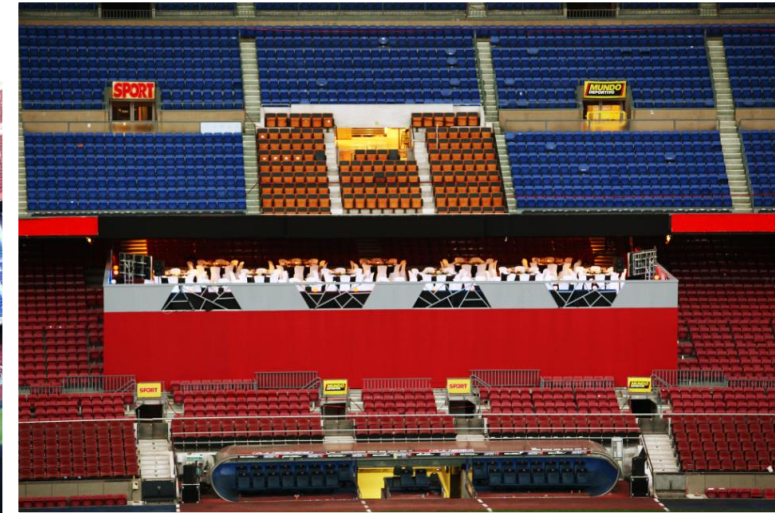

- Terrace integrated into the Grandstand with option of using its seating
- Catering service, offered while guests enjoy a visit around the Camp Nou facilities
- Cocktail capacity: **350 people (Presidential Area not included)**



Facility features: Banquet style

Camp Nou Terrace



Possibility of displays on plasma wall, video or plasma screens

Corporate presentations, awards, conventions, shows...

Banquet capacity: **320 people**



Facility features: Party

Camp Nou Terrace

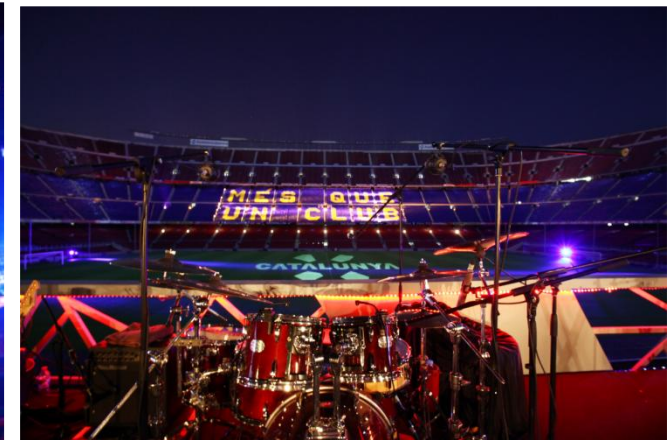

- Entertainment services available to liven up your event
- Lighting, sound and image packs plus facility customisation available
- Auditorium capacity: 1.200 people (making most of Grandstand seating)



Facility features: The Stadium

Camp Nou Terrace

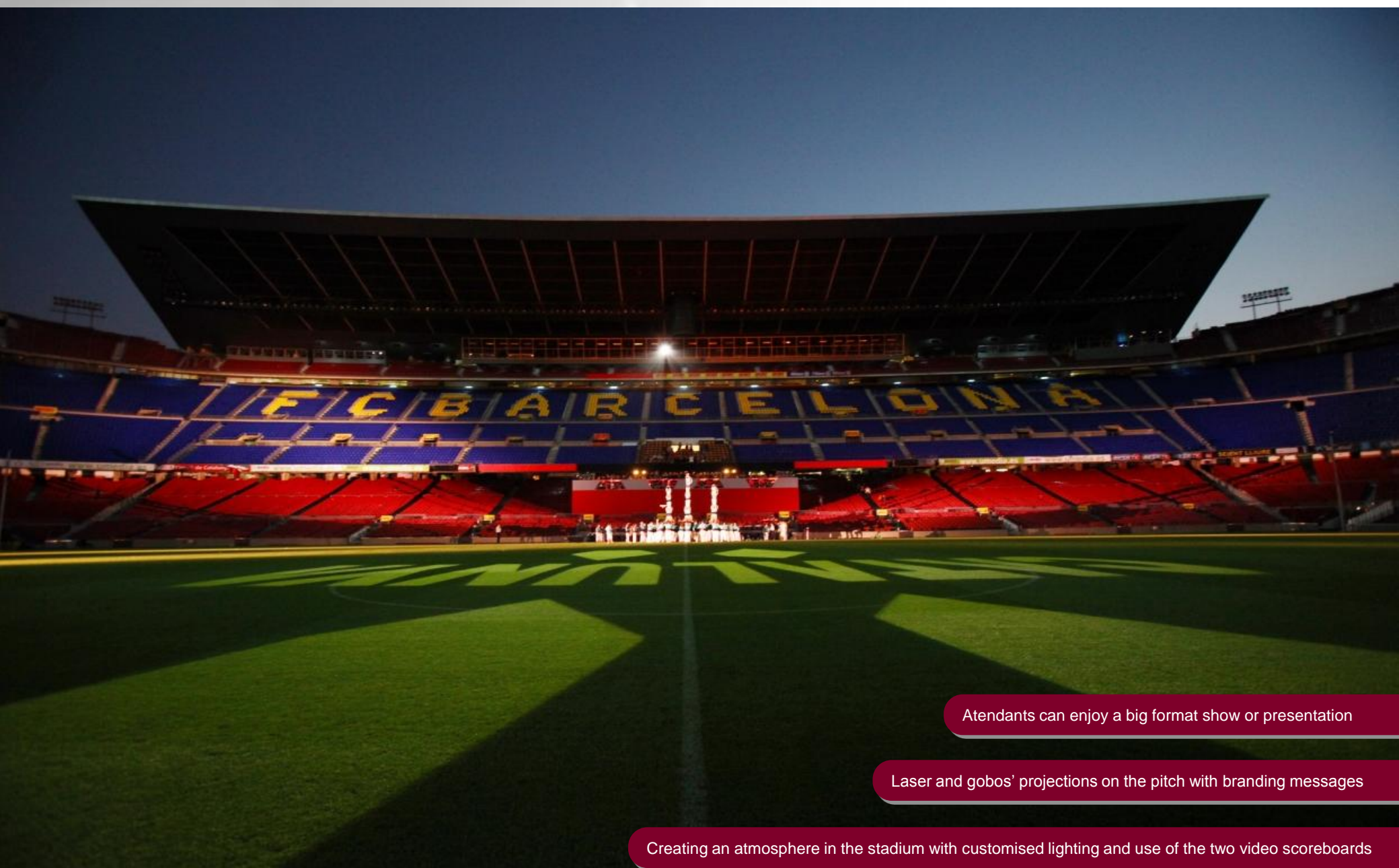

Atendants can enjoy a big format show or presentation

Laser and gobos' projections on the pitch with branding messages

Creating an atmosphere in the stadium with customised lighting and use of the two video scoreboards



- Cost of hiring the Camp Nou Platea:

On request

- Includes:

- ✓ Availability of the “Platea” facility from 7.30 pm to 1 am (or half day)
- ✓ “Basic” lighting pack
- ✓ Availability of “Grandstand Terrace”
- ✓ Use of the stadium’s two giant video scoreboards
- ✓ Attendance of the hostess during the event
- ✓ Parking for all attendees on the Camp Nou esplanade

- Extra Services

On request

- ✓ Plus lighting pack
- ✓ Set of plasma screens
- ✓ Sound pack
- ✓ Assembly of stage or dais for presentations and/or shows
- ✓ Projection “gobo” or “laser” on main façade or stadium pitch
- ✓ Giant back-lit cubes (2x2x2 meters) in the entrance area or on the track around the pitch
- ✓ Back-lit light columns in the guest arrival area or in the facility
- ✓ Hostess service for reception and check-in, cloakroom, accompaniment, etc...
- ✓ Shows and musical entertainment
- ✓ “Corporate” Camp Nou Tour
- ✓ Photo report and/or film of the event
- ✓ Totem signage with customized image
- ✓ Various catering services:

Gala Dinner

Cocktail dinner

Welcome drink

Themed cuisine, etc.



	Banquet	Cocktail	Auditorium	Location
✓ Platea Camp Nou	320 people	350 people	1.200 people	on level -1

Availability: From May to August

Adjoining Area

✓ Presidential Anteroom	80 personas	125 personas		on level 0
✓ Honor Anteroom	110 personas	160 personas		on level -1
✓ Foundation Room	70 personas	100 personas		on level -1
✓ FC Barcelona Muesum	250 personas	480 personas		on level 0
✓ Grandstand Hall	750 personas	1.000 personas		on level +1 i +2



Meetings & Events

Email: events@fcbarcelona.cat

Phone. 93 496 37 94 – 93 496 36 35 – 93 496 36 00

www.fcbarcelona.cat